

STURGO[®] COMPACT ELECTRIC STRADDLE STACKER

THE STURGO[®] LIFT RANGE

WHY?

REDUCE MANUAL HANDLING BY PROVIDING USERS WITH A SAFE AND EFFICIENT WAY OF POSITIONING PALLETS AT HEIGHTS. THE IDEAL SOLUTION WHERE A FORKLIFT WON'T DO.

- Electric handling of pallets with minimal working space required
- Prevent costly accidents from manually lifting, lowering and carrying
- Low energy consumption and high performance
- Simplified design to provide everything you need and nothing you don't
- Good for the environment - no nasty fuel emissions
- Quieter than combustion powered forklifts

KEY FEATURES

- Highly specialised drive and hydraulics
- Straddle chassis provides stability for high lifts
- Safety hydraulic feature prevents mast free-fall in case of hydraulic failure
- Emergency stop button
- Multi-lifting limited switch ensures travel safety
- Low speed mode automatic activation
- Anti-roll braking device
- Ergonomic handle with long arm
- Side-positioned user control ensures excellent visibility
- On-board battery charger
- Electric drive / electric lift

TECHNICAL BRIEF

- Capacity 1200kg
- Battery voltage/rated capacity 210Ah
- Electro-magnetic brake



Adjustable fork width



Adjustable stabiliser width



Ergonomic handle



Side-positioned user control



STURGO[®] COMPACT ELECTRIC STRADDLE STACKER

THE STURGO[®] LIFT RANGE

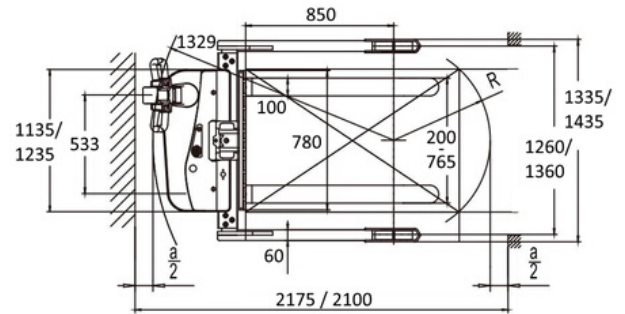
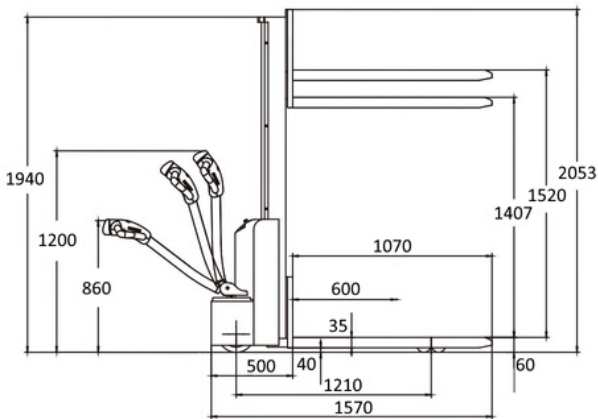

General

Model	11740241 / ES12-25MM
Capacity	1200 kg
Load Centre	600 mm
Lifting Type	Electric
Operating Type	Pedestrian

Wheels

Material	PU
Wheel Base	1210 mm
Quantity (driving/castor/bearing)	1/1/4
Driving Wheel	Ø210 x 70 mm
Castor Wheel	Ø100 x 50 mm
Bearing Wheel	Ø100 x 50 mm

Dimensions

Min. Fork Height	60 mm
Max. Fork Height	1520 mm
Overall Fork Width	200-765 mm
Overall Straddle Leg Width	1335-1435 mm
Fork Dimensions (length/width/depth)	1070/100/35 mm
Overall Dimensions (length/width/height)	1570/1335-1435/1940 mm
Min. Turning Radius	1329 mm

Performance

Travel Speed (laden/unladen)	4/4.5 km/h
Lifting Speed (laden/unladen)	12/22 mm/s
Lowering Speed (laden/unladen)	12/11 mm/s
Max. gradeability (laden/unladen)	3/10 %

Electrical

Drive Mode	DC
Drive Motor	24V 0.65Kw
Lift Motor	24V 2.2Kw
Battery Type	Maintenance-free gel
Battery Capacity	2 x 12V/105Ah

Weights

Battery Weight	2 x 25kg
Net Weight (includes battery)	543 kg